

By entering the area described in more detail below, the visitor is subject to the following

# INTERNAL REGULATIONS

of the organiser of the "Vienna Christmas Dream". [also available online at [www.wienerweihnachtstraum.at](http://www.wienerweihnachtstraum.at)]

Scope (hereinafter also referred to as "event area"): Wiener Rathauspark

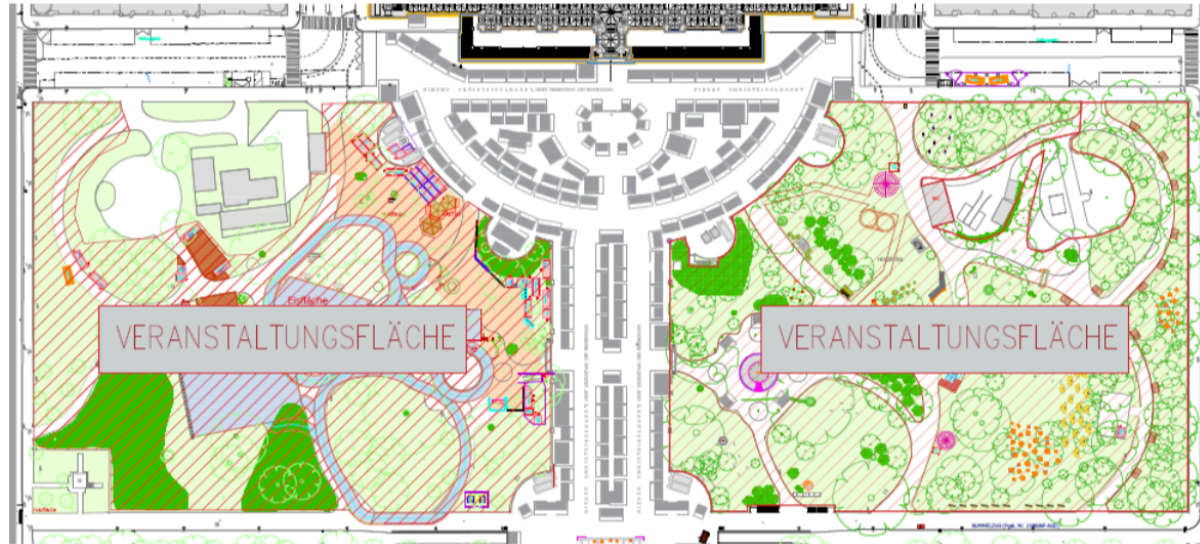

**Period of validity: 16/11/2018, 10:00 a.m. – 26/12/2018, 10:30 p.m.**

The term „visitor“ applies to both sexes.

All persons entering the event area must behave in such a way that other persons are not harmed, endangered or harassed. They must also behave in such a way that no damage is caused to structures, amenities, equipment or objects.

## CHECKS BY SECURITY STAFF

Any person wishing to enter the „Vienna Christmas Dream“ event area within the scope of these internal regulations expressly agrees to undergo any potential checks by the organiser’s security staff. In doing so, the instructions of the security staff are to be followed in full, otherwise entry will be refused.

The deployed security staff have the right to examine individuals whether they pose a security risk due to alcohol or drug use, or by carrying weapons or other dangerous objects. „Vienna Christmas Dream“ visitors expressly consent to their clothing and any containers that they carry to be searched accordingly.

The security staff have the right to refuse entry to any persons posing a security risk onto the grounds.

The same applies to persons who refuse to give consent for their clothing and any containers that they carry to be searched.

In individual cases, the security staff also have the right to carry out such checks on persons who are already on the grounds. In case of violation of the internal regulations, the organiser has the right to forcibly remove offenders from the grounds.

## ALCOHOL

**GENERAL ALCOHOL BAN FOR VISITORS BELOW 16 YEARS OF AGE; ANY CONSUMPTION OF ALCOHOLIC BEVERAGES BY VISITORS IS PROHIBITED**

According to section 11 Wr JSCHG 2002 in the current applicable version, it is generally prohibited for persons under the age of 16 to buy and/or consume alcoholic beverages in public places and/or at public events. In this respect, the organiser expressly reserves the right for employees and authorities to search visitors on site. Any violation will be reported and alcoholic beverages will be confiscated.

Bringing alcoholic beverages to the event area is prohibited. The offending receptacles will be confiscated without any claim for compensation. In this respect, the visitor agrees to the appropriate checks by employees of the organiser.

Excessive consumption of alcohol in the event venue is prohibited. The organiser reserves the right to forcibly remove heavily intoxicated persons who pose a threat to themselves and/or others at the event venue.

## ENVIRONMENTAL PROTECTION

**USE WASTE CONTAINERS, NO OTHER DISPOSAL OF WASTE ALLOWED IN THE EVENT AREA**

The visitors may only dispose of waste at the event area in the containers provided for this purpose.

**CLEANING OF THE AREA**

Cleaning the event space (excluding the ice rinks) takes place regularly from 9:00 a.m. to 10:30 p.m.

The ice rink is cleaned as necessary (where part of the ice surface is closed).

## NO-SMOKING POLICY

Smoking is prohibited across the entire ice rink.

## **VIDEO SURVEILLANCE**

The entire event area is monitored by video.

## **LIGHTING**

The lighting of the paths in the park takes place at nightfall by public lighting.

Routes to the wooden stage at the event area are lit up at nightfall by public lighting and additionally by the organiser.

The ice rinks will be lit from nightfall until closing time at 10:00 p.m.

## **ICE RINKS**

Reckless, fast skating is prohibited. If there is any overcrowding on the ice rinks, the entrances will be temporarily closed.

For events on the ice that are pre-announced, parts of the ice rink may be closed. In the event of thunderstorms, storms or heavy snowfall, operation will be partially or completely suspended due to official regulations. Pay attention to barriers!

The "children's area" can be used by children, beginners and wheelchair users free of charge for ice skating or travelling on the ice. Use is at your own risk.

The following is prohibited on all ice surfaces:

- Jumping over dividers, as well as sitting on dividers
- Walking on the ice surface without ice skates (Exception: curling lane at your own risk)
- Bringing animals and objects of any kind onto the ice surface (ceramic cups, glasses, water bottles, camera tripods, canes, prams, sledges, waveboards, large backpacks etc.)
- Smoking, drinking and eating on the ice surfaces
- Carrying children (e.g. on your shoulder)
- Discarding wrappers (this endangers the safety of other skaters!)
- Playing catch, forming chains and skating backwards
- Skating in the opposite direction of that specified

## **SAFETY, CONDUCT IN EMERGENCIES**

### **CARRYING DANGEROUS OBJECTS IS PROHIBITED**

Carrying any type of weapon or object that could be used as a weapon as well as any substance that could pose a threat, pyrotechnic items of any kind, flammable liquids, alcoholic beverages, drugs and other intoxicants, racist, xenophobic, Nazi, sexist or political propaganda material as well as any promotional (commercial, political or religious) items is prohibited.

In case of doubt, classifying items as prohibited or permitted within the meaning of these internal regulations is at the discretion of the site management and the responsible person in charge of the security staff.

Any persons who carry prohibited items within the meaning of these internal regulations will be refused entry onto the grounds. If persons with prohibited items are found on the grounds, the security staff reserve the right to forcibly remove the concerned persons from the grounds. If the persons concerned refuse to leave the grounds, the items are to be confiscated without claim for compensation.

Dogs must wear a muzzle and be kept on a lead.

### **NOTIFICATION OF SECURITY SERVICE AND/OR EMERGENCY SERVICES PERSONNEL**

In the event of danger (fire, accidents, violent incidents, etc.), the security service or emergency service personnel (fire brigade 122, police 133, rescue 144) must be informed immediately: Stay calm and pay attention to your own safety.

### **BEHAVIOUR IN THE EVENT OF SEVERE WEATHER (STORM, HAIL, THUNDERSTORM, BLACK ICE)**

In case of severe weather, the instructions (directions from security staff, loudspeaker announcements via public address systems) from the organiser must be strictly observed and the orders of the security staff are to be obeyed. Staying under trees as well as staying in the immediate vicinity of technical equipment can pose a particular threat.

### **BEHAVIOUR DURING VACATION OR EVACUATION**

In the event that it is necessary to vacate or evacuate the premises, it is essential to keep calm and to comply with orders from the organiser, the security staff, the emergency services personnel and loudspeaker announcements.

## **BAN ON VEHICLES**

There is a general ban on driving single and multi-track motorised vehicles across the entire grounds.

Driving on the grounds is only permitted with the express permission of the organiser and must always be done with the utmost caution and a maximum speed of 10 km/h (6.21 mph).

The use of non-motorised vehicles and sports equipment such as bicycles, scooters, inline skates, skateboards and roller skates is also prohibited across the entire grounds.

## **LEGAL CONSEQUENCES**

### **INFRINGEMENTS OF THE INTERNAL REGULATIONS OR OTHER LEGAL INFRINGEMENTS**

Any violation of these internal regulations may be prosecuted with a reprimand from the grounds. Possible (administrative) or criminally relevant behaviour will be reported to the competent authorities without exception. For this purpose, the security staff are authorised to record the personal data of offending persons. It is pointed out that a breach of the duties requiring action and abstention duties imposed in these internal regulations according to section 35 para. 1 of the Vienna Event Venues Act, LGBl. No. 4/1978 in the current applicable version in connection with 32 para. 3 of the Vienna Event Venues Act, LGBl. No. 12/1971 is punishable under criminal law.

According to section 35 para. 4 of the Vienna Venue Act, LGBl. No. 4/1978 in the current applicable version, persons who do not submit to these approved and imposed internal regulations may not stay on the grounds.

## **JURISDICTION**

JURISDICTION FOR EXECUTIVE; FIRE DEPARTMENT; SECURITY SERVICES, AND ORGANISERS WITH REGARD TO VISITORS

The visitors must immediately obey any orders from the executive, the fire brigade, the security personnel as well as the organiser themselves. Failure to comply may result in the person being removed from the event area.

## **SOUND AND IMAGE RECORDINGS**

VISITORS' CONSENT TO THE UTILISATION OF POSSIBLE RECORDINGS MADE OF THEM

Anyone entering the site declares their consent that sound and image recordings will be made of them free of charge, from which photos or other current and/or future media technology can be made and used free of cost by means of direct or time-delayed video display, direct or time-delayed transmission or other form of transmission or recording. Anyone entering the site accepts that they will make and/or transmit sound and/or image recordings for private use only. It is strictly forbidden, under all circumstances, to transmit sound and/or image material, entirely or in part, via the internet, radio, television or other current and/or future media, or to assist other persons in the performance of such activities. This does not apply to accredited journalists and holders of a valid press pass who are exercising their professional activity.

For television transmissions and other recordings, the visitors have given their consent to the transmitting television organisation that the recordings made of them during or in connection with the market may be utilised, without compensation and without any temporal or spatial restriction, using any technical procedure.